 <p>CEODEUX LPG-TEC</p> <p>ROTAREX GROUP</p>	<p align="center">INSTRUCTION MANUAL</p> <p align="center">80% fill-stop Valve</p> <p align="center"><i>Type A100 to A115 (070116-070127)</i></p>	<p>NT-A100-gb</p> <p>Rev.: 03</p> <p>Date: 18/08/2003</p> <p>Page : 1 / 5</p>
--	---	---

S U M M A R Y

1. DESCRIPTION	1
2. GENERAL SAFETY INSTRUCTIONS	1/2
3. TECHNICAL DATA	2
4. INSTALLATION INSTRUCTIONS AND HANDLING.....	2/3/4
5. MAINTENANCE	4
6. GENERAL CONDITIONS.....	5

ONLY THOSE PERSONS WHO HAVE READ THESE TECHNICAL INSTRUCTIONS THOROUGHLY AND UNDERSTAND THEM COMPLETELY SHALL BE AUTHORIZED TO USE THIS PRODUCT.

IMPORTANT NOTICE

If this product is being purchased or used for incorporation into another product (for example, a compressed gas valve for incorporation into a compressed gas cylinder), then **CEODEUX LPG Valves Technology S.A.** reminds the end product manufacturer that any and all product user warning, instructions or product labels are the responsibility of the end product manufacturer.

C O N T E N T

1. DESCRIPTION

These valves are intended and approved for use in LP-Gas fuel containers for the purpose of automatically terminating the flow of LP-Gas at the 80% level during refilling operations. This PRODUCT is not intended for any other installation or purpose. If the product user has any question regarding this PRODUCT proper application or purpose, the product user should call *352-32 78 32-1. Any non-approved use or application and/or any non-approved modification of the PRODUCT or its use or application may result in a serious accident or personal injury for which **CEODEUX LPG Valves Technology S.A.** will not be responsible.

2. GENERAL SAFETY REQUIREMENTS

- All users must comply fully with all national or local laws, rules or regulations in force.
- Anyone using this product must be thoroughly familiar with these instructions and other applicable product instructions and manuals.

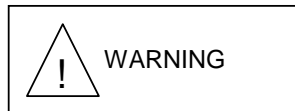

This PRODUCT is a component part designed for use with LP-Gas containers. The final manufacturer is responsible for preparing appropriate and adequate instructions and warnings for the ultimate product user.

- The maintenance instructions outlined below should be incorporated into any product manual or instruction label.
- Failure to follow any instruction or warning within this instruction manual or on any product label may result in a serious accident involving either personal injury, property damage or both.

- 2.1 Before every use, check the condition of the valve (cleanness, condition of threads), inform yourself about standards and safety regulations for valves used with gases.
- 2.2 Respect given torques for assembling the valve on the tank (see section 4)

CEODEUX LPG Valves Technology S.A. 24, route de Diekirch B.P.19 L-7505 Lintgen
reserves the possibility at any time to change technical contents without previous consent.

 <p>CEODEUX LPG-TEC</p> <p>ROTAREX GROUP</p>	<p>INSTRUCTION MANUAL</p> <p>80% fill-stop Valve</p> <p><i>Type A100 to A115 (070116-070127)</i></p>	<p>NT-A100-gb</p> <p>Rev.: 03</p> <p>Date: 18/08/2003</p> <p>Page : 2 / 5</p>
--	--	---

- 2.3 This product is designed and approved for the use with LPG tanks. Any other use or application is not permitted without a written autorisation by our technical Department.
- 2.4 Never disassemble a valve.
- 2.5 Never grease a valve (especially the inlet thread).
- 2.6 Never disassemble a valve from a tank under pressure.
- 2.7 Use only materials with cleanness surfaces and compatible with the specified gaz, the specified pressures and the desired flow.
- 2.8 The manufacturer of the end product has to look after the cleanness of the tank, which has to be free of grease and metallic, plastic or other particles.
- 2.9 The valve has to be stored in a dry and well tempered environment in its original packaging without any influence of sun or ultraviolet radiation.
- 2.10 The devices should not be subjected to any clash or impact or deformation: It is not permitted to use a deformed or damaged valve.
- 2.11 Never use a direct flame near the installation.
- 2.12 Never modify or remove the markings on the Valve.
- 2.13 All users must strictly respect all national or local laws, rules or regulations in force.
- 2.14 The manufacturer of the end product is responsible for any personal injury, material or immaterial accident or dammaging caused by a non-approved fitting or failure of maintenance.
- 2.15 The customer has to assure an appropriate transportation and handling of this product. **CEODEUX LPG Valves Technology S.A.** is not responsible if the product has been transported or handled in an inappropriate way and especially when its specific original packaging looks dammaged. In this case the customer has to inform the manufacturer **CEODEUX LPG Valves Technology S.A.** immediately.

3. TECHNICAL DATA

Working Pressure	30 bar maximum
Working Temperature	- 40° C + 70° C
Δp of filling	Min.1 bar (14,5PSI)/ max. 15 bar (217,5PSI)
Flow Rate at Δp	at $\Delta p=4bar$: 42l/min (liquid)
For use with the following gas	Propane, Butane or mixture of both (LPG)
Inlet	3/4" NPT
Outlet	In reference to customer specification
Markings Valve	Type, 3 stars, date (MM/YY), Listing number, \emptyset of tank, mounting angle, distance A (see fig.1), made in Luxembourg, TOP, Classe 3

Subject with modification without preliminary opinion

4. INSTALLATION AND HANDLING INSTRUCTIONS

The fitting of the Valve has to be done in the following order:

- 4.1 Fitting of the valve to the cylinder:
 - 4.1.1 Check if the marking of the valve correspond with the cylinder diameter and the mounting angle of the coupling or 4-hole-plate.
 - 4.1.2 Check if the valve thread correspond with the thread of cylinder's coupling: 3/4" NPT
 - 4.1.3 Use an appropriate sealing product for the threads (if the valve is not delivered with Everseal) that does not interfere with the correct function of the valve (e.g. Teflon tape or similar). Apply sealing product on threads only. Avoid any sealing product with lubrication effects (e.g. products containing oil or lead).
 - 4.1.4 Assure that the coupling is free of soiling like grease, painting color ...
 - 4.1.5 Locate the cylinder in that way, that the 80% stop-fill valve could be assembled in vertical position.

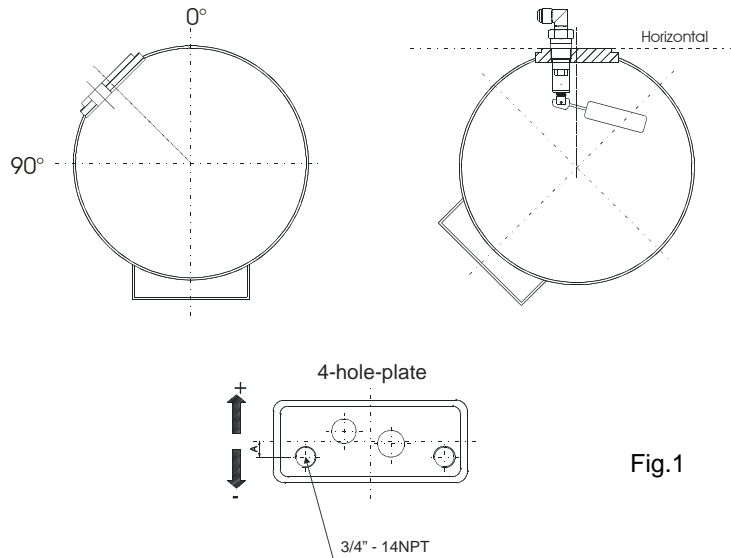
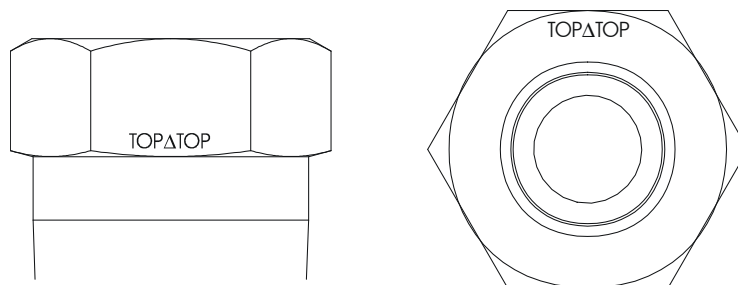

Fig.1

- 4.1.6 Install carefully the 80% stop-fill valve one turn by hand. The valve has to turn free without touching the cylinder inside in any way. Take caution that the float will not be damaged.
- 4.1.7 Check that the float turns freely within the whole operation.
- 4.1.8 Use a special tool corresponding to the valve's wrench (for 1 3/4" – 6 ACME → 32mm; for 1/2" SAE → 27mm) to fit the valve to the cylinder to avoid any deformation.

**Fitting torque: 100 NM + orientation of triangle TOP in the mounting direction of the float
(max. 130Nm after orientation):
Number of engaged thread turns: 5 minimum to 8 maximum**

These fitting torques must be respected; If a leakage occurs after correct assembly of the valve into the cylinder, check the thread of the cylinder coupling.



- 4.1.9 During fixing or unscrewing of the filling connection or the filling elbow, fix the valve with a tool to protect against unscrewing or deformation
- 4.1.10 After fitting check the assembly for leaks (e.g. with a leak detecting spray. Any fire or direct flame is prohibited during this operation).

IMPORTANT NOTE:

After the assembly, the cylinder must be purged to guarantee a correct function of the 80% Fill-stop valve. The correct function of the 80% fill-stop valve could only be guaranteed if the valve is used in 100% LP-Gas.

 <p>CEODEUX LPG-TEC</p> <p>ROTAREX GROUP</p>	<p>INSTRUCTION MANUAL</p> <p>80% fill-stop Valve</p> <p><i>Type A100 to A115 (070116-070127)</i></p>	<p>NT-A100-gb</p> <p>Rev.: 03</p> <p>Date: 18/08/2003</p> <p>Page : 4 / 5</p>
--	--	---

4.2 Fitting of the elbow to the valve

- 4.2.1 Check if the Elbow thread correspond with the thread of the valve: 3/8" NPT
- 4.2.2 Use an appropriate sealing product for the threads (if the Elbow is not delivered with Everseal) that does not interfere with the correct function of the valve (e.g. Teflon tape or similar). Apply sealing product on threads only. Avoid any sealing product with lubrication effects (e.g. products containing oil or lead).
- 4.2.3 Install carefully the Elbow one turn by hand on the Valve.
Use a special tool corresponding to the Elbow wrench (15mm) to fit it to the valve, in order to avoid any deformation. Fix the valve during the whole operation with a tool to protect against unscrewing or deformation.

Fitting torque: 51 NM + orientation (max. 70Nm after orientation):

These fitting torques must be respected.

- 4.2.4 During fixing or unscrewing of the filling connection to the elbow, fix the elbow with a proper tool to protect against unscrewing or deformation
- 4.2.5 After fitting check the assembly for leaks (e.g. with a leak detecting spray)
Any fire or direct flame is prohibited during this operation.

5. MAINTENANCE

The warranty foreseen in our general conditions of sale does not cover the following:

- Repair or replacement due to normal wear or damage during routine maintenance.
- Damage to components whose fragility is for technical reasons unavoidable and determined by product design.
- Damage from not following recommended maintenance and procedures, as outlined in this instruction manual.
- Damage arising from modifications not included in the procedures in this instruction manual.
- Damage resulting from the use of an unauthorised part, supplied, manufactured or modified by procedures not included in this instruction manual.



Failure to follow the installation instructions and handling instructions may cause an accident or personal injury, for which **CEODEUX LPG Valves Technology S.A.** declines any responsibility.

Maintenance, repairs and reconditioning of the PRODUCT are under the responsibility of the user or the operator. Anyone attempting to maintain, repair or conditioning the PRODUCT must be thoroughly familiar with **ECE R67-01, Directive 97/23/EC, NFPA No.58** and all other standards and regulations referenced therein.

According to this standards maintenance, repair and/or reconditioning shall be performed by properly trained personal.

In case of incident or complaint, the user has to send back the supposed defective product to the manufacturer **CEODEUX LPG Valves Technology S.A.** securely packed. In order to preserve the warranty, the user will not execute any intervention on the product (disassembling, repair, modification...) without our written agreement.

 <p>CEODEUX LPG-TEC ROTAREX GROUP</p>	<p>INSTRUCTION MANUAL 80% fill-stop Valve <i>Type A100 to A115 (070116-070127)</i></p>	<p>NT-A100-gb Rev.: 03 Date: 18/08/2003 Page : 5 / 5</p>
---	--	--

6. GENERAL CONDITIONS

- 6.1. Because of a policy of continuous product improvement, **CEODEUX LPG Valves Technology S.A.** reserves the right to change designs and materials as well as specifications and product informations without notice.
- 6.2. **CEODEUX LPG Valves Technology S.A.** preserves completely the intellectual property of their projects, studies and in general on all documents forwarded to their customers : it is not permitted to communicate, to execute or to use these documents in any way without their written authorisation.
- 6.3. This instruction manual is a part of the sales contract and is subject to the general terms of sale.